

GOVERNMENT OF SINDH
RURAL DEVELOPMENT DEPARTMENT



BIDDING DOCUMENT
FOR

CONSTRUCTION OF LINK ROAD FROM JAM SAHIB-SHAHPUR CHAKAR ROAD @ PREETAM ABAD TO DIM
BRANCH JAMRAO I.C LINK VILLAGE , AKBAR LEGHARI, TAMACHI KOOLHI, GULAB KHASKHELI AND DANO
KOOLHI TALUKA NAWAB SHAH DISTRICT SHAHEED BENAZEER ABAD.

ISSUED TO :-

DATE OF ISSUE:-

D.R No. & DATE:-

AMOUNT Rs.

EXECUTIVE ENGINEER
RURAL DEVELOPMENT DEPARTMENT
S. BENAZEER ABAD

**OFFICE OF THE EXECUTIVE ENGINEER
RURAL DEVELOPMENT DEPARTMENT S. BENAZEER ABAD**

B-1 TENDER SHEET

NAME OF WORK:- **CONSTRUCTION OF LINK ROAD FROM JAM SAHIB-SHAHPUR CHAKAR ROAD
@ PREETAM ABAD TO DIM BRANCH JAMRAO I.C LINK VILLAGE , AKBAR
LEGHARI, TAMACHI KOOLHI, GULAB KHASKHELI AND DANO KOOLHI
TALUKA NAWAB SHAH DISTRICT SHAHEED BENAZEER ABAD.**

NAME OF CONTRACTOR/ FIRM _____

D.R No. _____ DATED _____

D.R No. _____ DATED _____ AMOUNT Rs. _____

BANK BRANCH _____

EXECUTIVE ENGINEER
RURAL DEVELOPMENT DEPARTMENT
S. BENAZEER ABAD

BIDDING DATA

(This section should be filled in by the Engineer/Procuring Agency before issuance of the Bidding Documents. The following specific data for the works to be tendered shall complement, amend, or supplement the provisions in the Instructions to Bidders. Wherever there is a conflict, the provisions herein shall prevail over those in the Instructions to Bidders.)

Instructions to Bidders

Clause Reference

1.1 Name of Procuring Agency

Executive Engineer Rural Development Department S.BENAZIRABAD

(Insert name of the Procuring Agency)

Brief Description of Works

CONSTRUCTION OF LINK ROAD FROM JAM SAHIB-SHAHPUR CHAKAR ROAD @ PREETAM ABAD TO DIM BRANCH JAMRAO I.C LINK VILLAGE , AKBAR LEGHARI, TAMACHI KOOLHI, GULAB KHASKHELI AND DANO KOOLHI TALUKA NAWAB SHAH

5.1 (a) Procuring Agency's address:

Executive Engineer Rural Development Department S.BENAZIRABAD
District council office building premises shaheed Benazeer Abad

(Insert address of the Procuring Agency with telex/fax)

(b) Engineer's address:

Executive Engineer Rural Development Department S.BENAZIRABAD
District council office building premises shaheed Benazeer Abad

(Insert name and address of the Engineer, if any, with telex/fax.)

10.3 Bid shall be quoted entirely in Pak. Rupees. The payment shall be made in Pak. Rupees.

11.2 The bidder has the financial, technical and constructional capability necessary to perform the Contract as follows: (Insert required capabilities and documents)

- i. Financial capacity: (must have turnover of Rs----Million);
- ii. Technical capacity (mention the appropriate category of registration with PEC and qualification and experience of the staff);
- iii. Construction Capacity: (mention the names and number of equipments required for the work).

Sindh Public Procurement Regulatory Authority | www.pprasindh.gov.pk 18

12.1 (a) A detailed description of the Works, essential technical and performance characteristics.

(b) Complete set of technical information, description data, literature and drawings as required in accordance with Schedule B to Bid, Specific Works Data. This will include but not be limited to a sufficient number of drawings, photographs, catalogues, illustrations and such other information as is necessary to illustrate clearly the significant characteristics such as general construction dimensions and other relevant information about the works to be performed.

13.1 Amount of Bid Security

2 % of Bid Amount

(Fill in lump sum amount or in % age of bid amount /estimated cost, but not below 1% and not exceeding 5%)

14.1 Period of Bid Validity

60 days

(Fill in "number of days" not exceeding 90)

14.4 Number of Copies of the Bid to be submitted:

One original plus 2 copies.

14.6 (a) Procuring Agency's Address for the Purpose of Bid Submission

Executive Engineer Rural Development Department S.BENAZIRABAD

(insert postal address or location of bid box for delivery by hand)

15.1 Deadline for Submission of Bids

Time: - 01 PM on 13-01-2015

*16.1 Venue, Time, and Date of Bid Opening

Venue: District council office building premises shaheed Benazeer Abad

Time: 02 pm Date: 13-01-15

16.4 Responsiveness of Bids

(i) Bid is valid till required period,

Sindh Public Procurement Regulatory Authority | www.pprasindh.gov.pk 19

*(ii) Bid prices are firm during currency of contract/Price adjustment;

(iii) Completion period offered is within specified limits,

(iv) Bidder is eligible to Bid and possesses the requisite experience, capability and qualification.

(v) Bid does not deviate from basic technical requirements and

(vi) Bids are generally in order, etc.

*Procuring agency can adopt either of two options. (Select either of them)

(a) Fixed Price contract: In these contracts no escalation will be provided during currency of the contract and normally period of completion of these works is upto 12 months.

(b) Price adjustment contract: In these contracts escalation will be paid only on those items and in the manner as notified by Finance Department, Government of Sindh, after bid opening during currency of the contract.

CONTRACT DATA

(Note: Except where otherwise indicated, all Contract Data should be filled in by the Procuring Agency prior to issuance of the Bidding Documents.)

Sub-clauses of
Conditions of Contract

1.1.3-Procuring Agency's Drawings, if any
(To be listed by the Procuring Agency)

1.1.4 The Procuring Agency means
RURAL DEVELOPMENT DEPARTMENT

1.1.5 The Contractor means

1.1.7 Commencement Date means the date of issue of Engineer's Notice to Commence which shall be issued within fourteen (14) days of the signing of the Contract Agreement.

1.1.9 Time for Completion 180 days
(The time for completion of the whole of the Works should be assessed by the Procuring Agency)

1.1.20 Engineer (mention the name along with the designation including whether he belongs to department or consultant) and other details

Executive Engineer Rural Development Department S.BENAZIRABAD

1.3 Documents forming the Contract listed in the order of priority:

- (a) The Contract Agreement
- (b) Letter of Acceptance
- (c) The completed Form of Bid
- (d) Contract Data
- (e) Conditions of Contract
- (f) The completed Schedules to Bid including Schedule of Prices
- (g) The Drawings, if any
- (h) The Specifications
- (i) _____
- (j) _____

(The Procuring Agency may add, in order of priority, such other documents as form part of the Contract. Delete the document, if not applicable)

OFFICE OF THE EXECUTIVE ENGINEER
RURAL DEVELOPMENT DEPARTMENT SHAHEED BENAZIRABAD



Issued to Mr./Messrs: _____
Vide D.R. No. _____ Dated _____ for Rs. _____
Date of Issue _____ Date of Opening _____

Executive Engineer
Rural Development Department
Shaheed Benazirabad

TENDER FOR WORKS

I/We tender for the execution for the Government of Sindh (herein before and herein after referred to as "Government") of the work specified in the underwritten memorandum within the time specified in such memorandum at @ **Part-(A)** _____ percent below / above @ **Part-(B)** _____ percent below / above the estimate rates entered in Schedule 'B' memorandum showing item of work to be carried-out and in accordance in all respect with the specifications/ designs, drawings and instructions in writing referred to in rule hereof and clause 12 of annexed conditions of contract.

MEMORANDUM

General Description:- **CONSTRUCTION OF LINK ROAD FROM JAM SAHIB SHAHOUR CHAKAR ROAD @ PREETAM ABAD TO DIM BRANCH JAMRAO I.C LINK VILLAGE, AKBAR LEGHARI, TAMACHI KOOLHI, GULAB KHASKHELI & DANO KOHLI TALUKA NAWAB SHAH, DISTRICT SHAHEED BENAZIRABAD.**

- | | | |
|------|---|-------------------|
| i) | Estimated Cost | Rs. 60.00 Million |
| ii) | Earnest Money | Rs. 1.20 Million |
| iii) | Percentage if any to be deducted from bill @ 8% | Rs. _____ |
| iv) | Security Deposit i/c earnest money @ 10% | Rs. _____ |
| v) | Time allowed for the completion of work. | <u>06 Months</u> |

Should this tender be accepted I/We agree to a bid by and fulfill the terms and provisions of the conditions of contract annexed hereto as for as applicable and default thereof to forfeit and pay to Government the sum of money mentioned in the said conditions.

RECEIPT NO. _____ DATE _____ From _____

In respect of the sum of Rs. _____ Call Deposit No. _____ dated _____ from _____ Bank is herewith forwarded representing earnest money. The full value of which is to be absolutely forfeited to Government should I/We not deposit the full amount of security deposit as shown in the above memorandum in accordance with clause of the said conditions. Otherwise the sum of Rs. _____ shall be retained by Government on account of such security deposit as aforesaid or (B) the full value shall be retained by the Government on account of the Security specified in clause 1 (b) of the condition (Schedule-A is attached).

Contractor's
Signature

Executive Engineer
Rural Development Department
Shaheed Benazirabad

BILL OF QUANTITIES

DESCRIPTION AND RATE OF ITEMS BASED ON COMPOSITE SCHEDULE OF RATES.

ROAD PART - A

Name of Work:- **CONSTRUCTION OF LINK ROAD FROM JAM SAHIB SHAHOUR CHAKAR ROAD @ PREETAM ABAD TO DIM BRANCH JAMRAO I.C LINK VILLAGE, AKBAR LEGHARI, TAMACHI KOOLIH, GULAB KHASKHELI & DANO KOHLI TALUKA NAWAB SHAH, DISTRICT SHAHEED BENAZIRABAD.**

S #	Description	Quantity	Rate	Unit	Amount
1)	Earth work for road embankment by bulldozer including plugging mixing clod breaking dressing and compacting with optimum moisture content lead up to 100ft lift up to 5ft in all type of soils except rock if earth work is done by other the departmental agency for 85 % modified A A S H O density extra two miles lead. (C.S.H.W.P.1&2 It.3, A)	1863147.00	8681.43	% Cft	16174780.00
2)	Earth work for road embankment by bulldozer including plugging mixing clod breaking dressing and compacting with optimum moisture content lead up to 100ft lift up to 5ft in all type of soils except if earth work is done by other departmental agency for 95 -100 modified AASHO density extra two mile lead (C.S.H.W.P.1&2 It.6(A)	303303.00	11215.37	% Cft	3401655.00
3)	Preparing sub-base course by supplying & spreading stone metal 1-1/2" to 2" gauge of approved quality from approved quarry in required thickness to proper camber and grade i/c hand packing filling voids with 10cft of screening and non plastic quarry fines of approved quality & gauge from approved source watering & compacting to achieve 98-100 % density as per modified AASHO specification rate all cost of materials T&P carriage upto 3 chains). (C.S.H.W.P.3 It.8 (A)	129987.00	9676.14	% Cft	12577724.00
4)	Laying on bricks on end edging including supply of 9" x 4 1/2" x 3" 1 st class burnt bricks excavation for laying edging with small size parallel to the road. Rate includes all cost of materials labour and carriage to the site of work.	42900.00	2750.80	% Rft	1180085.00
4)	Preparing base course supplying & spreading stone metal of approved quality properly graded to maximum size of 1 1/2" in required thickness to proper camber & grade i/c supplying lying spreading 15cft screening; non plastic quarry fines filling depressions with stone metal after initial rolling i/c watering and compaction the same so as to achieve 100 % density as per modified AASHO specification (Rate i/c providing using templates camber plates screen from as directed) Rate all cost of material T&P carriage up to site of work. (C.S.H.W.P.No.4. It.No.10		10731.90	% Cft	13950075.00
5)	Providing surface dressing (3 coat) on new or existing surface with (40+25+1.4)= 79 Lbs bitumen per Sft of 80/100 penetration from Karachi and (5.5+.75+1.50)= 9.75 Cft crush bajri size 3/4", 1/2", 3/8", 1/8" respectively per % Sft carriage up to site of work (using crush bajri). (C.S.HWP.6 It.16, B)	259974.00	1684.08	% Sft	4378170.00
TOTAL				Rs,	51662489.00
_____ % Above / Below on the rates of CSR				Rs,	
G.TOTAL				RS,	

Rupees in Works:- _____

CONTRACTOR'S
SIGNATURE

EXECUTIVE ENGINEER
RURAL DEVELOPMENT DEPARTMENT
SHAHEED BENAZIRABAD

BILL OF QUANTITIES

DESCRIPTION AND RATE OF ITEMS BASED ON COMPOSITE SCHEDULE OF RATES.

ROAD CULVERT PART - B

Name of Work:- **CONSTRUCTION OF LINK ROAD FROM JAM SAHIB SHAHOUR CHAKAR ROAD @ PREETAM ABAD TO DIM BRANCH JAMRAO I.C LINK VILLAGE, AKBAR LEGHARI, TAMACHI KOOLHI, GULAB KHASKHELI & DANO KOHLI TALUKA NAWAB SHAH, DISTRICT SHAHEED BENAZIRABAD.**

S.#	Description	Quantity	Rate	Unit	Amount
1)	Excavation in foundation of building bridges and other structure including dug belling dressing refilling around structure with excavated earth watering ramming lead up to 5ft in ordinary soil. (C.S.P.4&5.It.18(B))	7402.08	3176.25	%o Cft	23511.00
2)	Cement concrete brick or stone ballast 1-½" to 2" gage in ratio 1:4:8 etc. (C.S.P.14.It.4(A))	1676.30	9416.28	% Cft	157845.00
3)	Pacca brick work in foundation and plinth in cement sand mortar (1:6)	2478.55	11948.36	% Cft	296146.00
4)	Errection & removal of centering for RCC or plain C.C works of partial wood (Vertical). (C.S.P. 17. It. 19(B)).	169.82	3127.41	% Sft	5311.00
5)	Cement concrete plain including placing compacting, finishing and curing, including screening and washing of stone aggregate without shuttering. Ratio 1:2:4. (C.S.P.18.It.5(A))	439.29	14429.25	% Cft	63386.00
6)	Fabrication of mild steel reinforcement for C.C i/c cutting bending laying in position making joints and fastening i/c cost of binding wire also includes removal of rust from bars. (Use Tor Bar). (C.S.P.20.It.7(B))	29.443	4820.20	P. Cwt	141921.00
7)	R. C. C work including all labor and material except the cost of steel reinforcement its labor for bending binding which will be paid separately this rate also i/c all kinds of forms mould lifting shuttering curing rendering finishing the exposed surface i/c screening washing of shingle RCC Work in roof slab beams columns rafts lintels & other structural members laid in situ or precast laid in position complete in all respect. (C.S.P.18 19.It.6 A(i))	567.49	337.00	P Cft	191244.00
8)	Cement plaster (1:3) upto 20 ft height ½" thick	1463.00	2344.59	% Sft	34201.00
Total				Rs,	913665.00
_____ % Above / Below on the rates of CSR				Rs,	
G.TOTAL				RS,	

Rupees in Works:- _____

CONTRACTOR'S
SIGNATURE

EXECUTIVE ENGINEER
RURAL DEVELOPMENT DEPARTMENT
SHAHEED BENAZIRABAD

TYPICAL X-SECTION OF ROAD

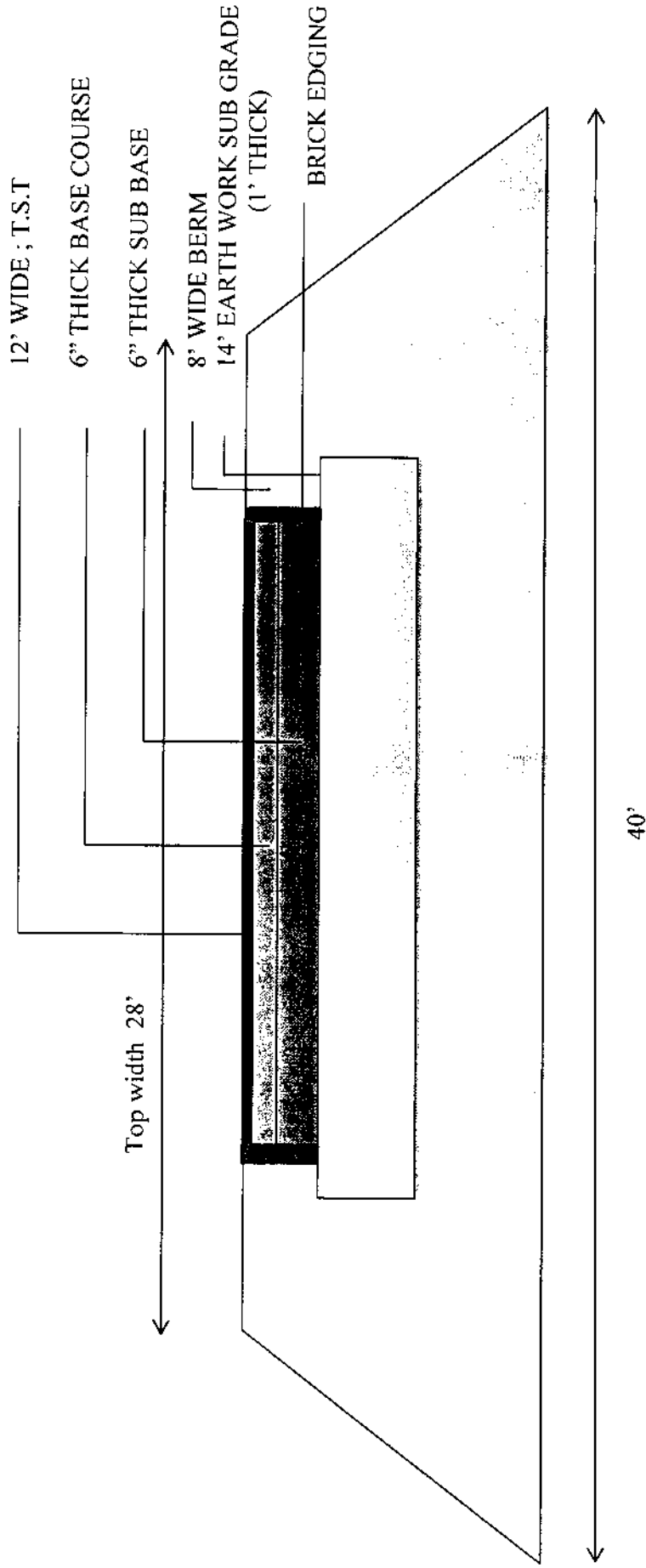

DISTRICT OFFICER (TECH)
RURAL DEVELOPMENT DEPARTMENT

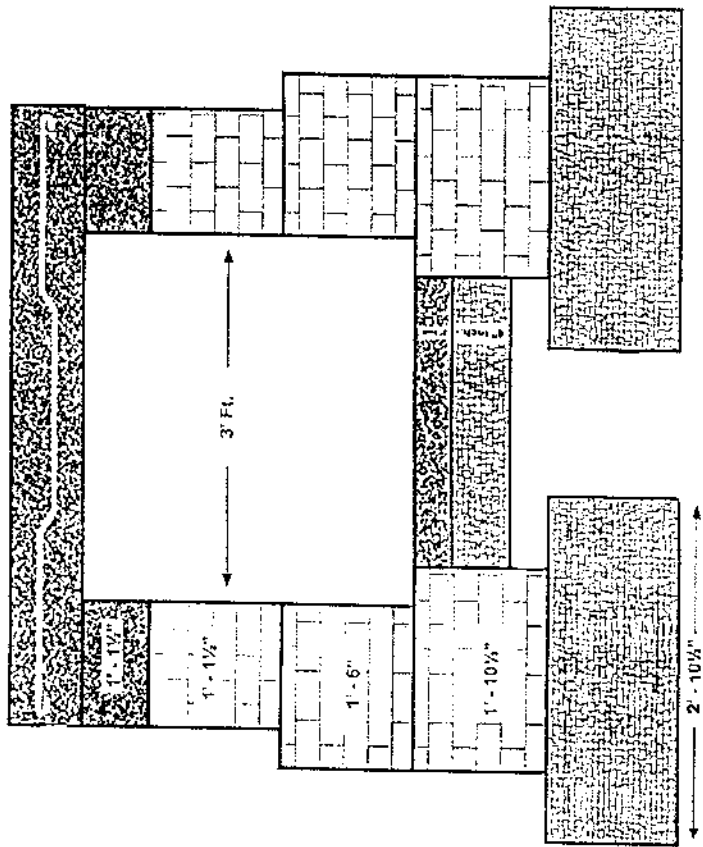
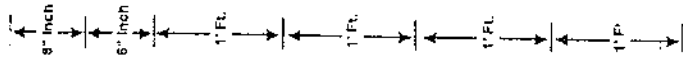
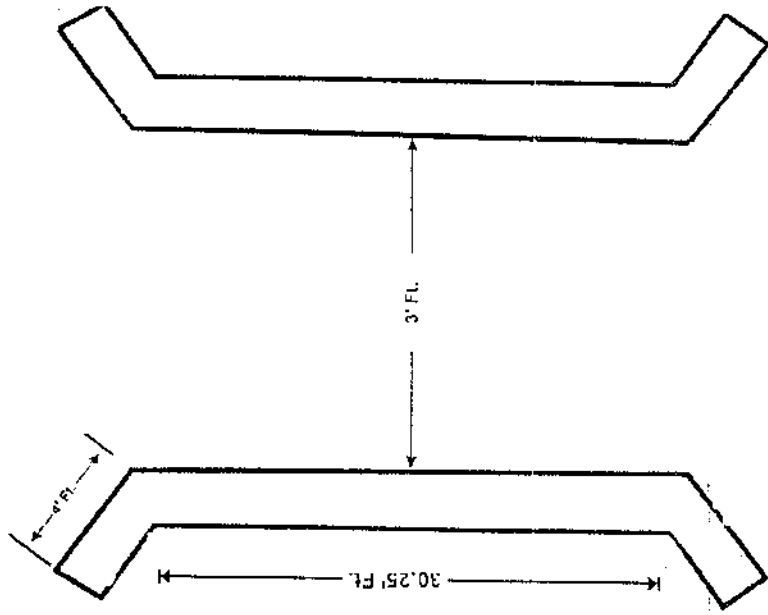

GOVERNMENT OF SINDH
RURAL DEVELOPMENT DEPARTMENT



BIDDING DOCUMENT
FOR

CONSTRUCTION OF LINK ROAD FROM SHAHDADPUR-LUNDO RAILWAY STATION ROAD @ MILE 3/3 TO VILLAGE
GHULAM RASOOL ZARDARI I.C APPROACH TO MASJID, DISTRICT SANGHAR.

ISSUED TO :- _____

DATE OF ISSUE:- _____

D.R No. & DATE:- _____

AMOUNT Rs. _____

EXECUTIVE ENGINEER
RURAL DEVELOPMENT DEPARTMENT
S.BENAZIRABAD

**OFFICE OF THE EXECUTIVE ENGINEER
RURAL DEVELOPMENT DEPARTMENT S.BENAZIRABAD**

B-1 TENDER SHEET

NAME OF WORK:-

**CONSTRUCTION OF LINK ROAD FROM SHAHDADPUR-LUNDO RAILWAY STATION
ROAD @ MILE 3/3 TO VILLAGE GHULAM RASOOL ZARDARI I.C APPROACH TO
MASJID, DISTRICT SANGHAR.**

NAME OF CONTRACTOR/ FIRM _____

D.R No. _____ DATED _____

D.R No. _____ DATED _____ AMOUNT Rs. _____

BANK BRANCH _____

EXECUTIVE ENGINEER
RURAL DEVELOPMENT DEPARTMENT
S.BENAZIRABAD

BIDDING DATA

(This section should be filled in by the Engineer/Procuring Agency before issuance of the Bidding Documents. The following specific data for the works to be tendered shall complement, amend, or supplement the provisions in the Instructions to Bidders. Wherever there is a conflict, the provisions herein shall prevail over those in the Instructions to Bidders.)

Instructions to Bidders

Clause Reference

1.1 Name of Procuring Agency

Executive Engineer Rural Development Department S.BENAZIRABAD

(Insert name of the Procuring Agency)

Brief Description of Works

CONSTRUCTION OF LINK ROAD FROM SHAHDADPUR-LUNDO RAILWAY STATION ROAD @ MILE 3/3 TO VILLAGE GHULAM RASOOL ZARDARI I.C APPROACH TO MASJID, DISTRICT SANGHAR.

5.1 (a) Procuring Agency's address:

Executive Engineer Rural Development Department S.BENAZIRABAD
District council office building premises shaheed Benazeer Abad

(Insert address of the Procuring Agency with telex/fax)

(b) Engineer's address

Executive Engineer Rural Development Department S.BENAZIRABAD
District council office building premises shaheed Benazeer Abad

(Insert name and address of the Engineer, if any, with telex/fax.)

10.3 Bid shall be quoted entirely in Pak. Rupees. The payment shall be made in Pak. Rupees.

11.2 The bidder has the financial, technical and constructional capability necessary to perform the Contract as follows: (Insert required capabilities and documents)

- i. Financial capacity: (must have turnover of Rs----Million);
- ii. Technical capacity: (mention the appropriate category of registration with PEC and qualification and experience of the staff);
- iii. Construction Capacity: (mention the names and number of equipments required for the work).

Sindh Public Procurement Regulatory Authority | www.pprasindh.gov.pk 18

12.1 (a) A detailed description of the Works, essential technical and performance characteristics.

(b) Complete set of technical information, description data, literature and drawings as required in accordance with Schedule B to Bid, Specific Works Data. This will include but not be limited to a sufficient number of drawings, photographs, catalogues, illustrations and such other information as is necessary to illustrate clearly the significant characteristics such as general construction dimensions and other relevant information about the works to be performed.

13.1 Amount of Bid Security

2 % of Bid Amount

(Fill in lump sum amount or in % age of bid amount /estimated cost, but not below 1% and not exceeding 5%)

14.1 Period of Bid Validity

60 days

(Fill in "number of days" not exceeding 90)

14.4 Number of Copies of the Bid to be submitted:

One original plus 2 copies.

14.6 (a) Procuring Agency's Address for the Purpose of Bid Submission

Executive Engineer Rural Development Department S.BENAZIRABAD

(insert postal address or location of bid box for delivery by hand)

15.1 Deadline for Submission of Bids

Time: 01 PM on 13-01-2015 .

16.1 Venue, Time, and Date of Bid Opening

Venue: **District council office building premises shaheed Benazeer Abad**

Time: 02 pm Date: 13-01-15

16.1.1 Responsiveness of Bids

(i) Bid is valid till required period,

Sindh Public Procurement Regulatory Authority | www.pprasindh.gov.pk 19

***(ii) Bid prices are firm during currency of contract/Price adjustment;**

(iii) Completion period offered is within specified limits,

(iv) Bidder is eligible to Bid and possesses the requisite experience, capability and qualification.

(v) Bid does not deviate from basic technical requirements and

(vi) Bids are generally in order, etc.

*Procuring agency can adopt either of two options. (Select either of them)

(a) Fixed Price contract: In these contracts no escalation will be provided during currency of the contract and normally period of completion of these works is upto 12 months.

(b) Price adjustment contract: In these contracts escalation will be paid only on those items and in the manner as notified by Finance Department, Government of Sindh, after bid opening during currency of the contract.

CONTRACT DATA

(Note: Except where otherwise indicated, all Contract Data should be filled in by the Procuring Agency prior to issuance of the Bidding Documents.)

Sub-Clauses of

Conditions of Contract

1.1.3 Procuring Agency's Drawings, if any

(To be listed by the Procuring Agency)

1.1.4 The Procuring Agency means

RURAL DEVELOPMENT DEPARTMENT

1.1.5 The Contractor means

1.1.7 Commencement Date means the date of issue of Engineer's Notice to Commence which shall be issued within fourteen (14) days of the signing of the Contract Agreement.

1.1.9 Time for Completion 180 days

(The time for completion of the whole of the Works should be assessed by the Procuring Agency)

1.1.20 Engineer (ment on the name along with the designation including whether he belongs to department or consultant) and other details

Executive Engineer Rural Development Department

S. BENAZIRABAD

1.3 Documents forming the Contract listed in the order of priority:

(a) The Contract Agreement

(b) Letter of Acceptance

(c) The completed Form of Bid

(d) Contract Data

(e) Conditions of Contract

(f) The completed Schedules to Bid including Schedule of Prices

(g) The Drawings, if any

(h) The Specifications

(i) _____

(j) _____

(The Procuring Agency may add, in order of priority, such other documents as form part of the Contract. Delete the document, if not applicable)

2.1 Provision of Site: On the Commencement Date

3.1 Authorized person: Executive Engineer Rural Development Department

S.BENAZIRABAD

3.2 Name and address of Engineer's/Procuring Agency's representative

Executive Engineer Rural Development Department

S.BENAZIRABAD

4.4 Performance Security:

Amount 2%

Validity _____

(Form: As provided under Standard Forms of these Documents)

5.1 Requirements for Contractor's design (if any):

Specification Clause No's _____

7.2 Programme:

Time for submission: Within fourteen (14) days* of the Commencement Date.

Form of programme: _____ (Bar Chart/CPM/PERT or other)

7.4 Amount payable due to failure to complete shall be ___% per day up to a maximum of (10%) of sum stated in the Letter of Acceptance

(Usually the liquidated damages are set between 0.05 percent and 0.10 percent per day.)

7.5 Early Completion

In case of earlier completion of the Work, the Contractor is entitled to be paid bonus up-to limit and at a rate equivalent to 50% of the relevant limit and rate of liquidated damages stated in the contract data.

9.1 Period for remedying defects

10.2 (e) Variation procedures:

Day work rates _____

(details)

11.1 Terms of Payments

OFFICE OF THE EXECUTIVE ENGINEER
RURAL DEVELOPMENT DEPARTMENT SHAHEED BENAZIRABAD



Issued to Mr./Messrs: _____

Vide D.R. No. _____ Dated _____ for Rs. _____

Date of Issue _____ Date of Opening _____

Executive Engineer
Rural Development Department
Shaheed Benazirabad

TENDER FOR WORKS

I/We tender for the execution for the Government of Sindh (herein before and herein after referred to as "Government") of the work specified in the underwritten memorandum within the time specified in such memorandum at @ Part-(A) _____ percent below / above @ Part-(B) _____ percent below / above the estimate rates entered in Schedule 'B' memorandum showing item of work to be carried-out and in accordance in all respect with the specifications/ designs, drawings and instructions in writing referred to in rule hereof and clause 12 of annexed conditions of contract.

MEMORANDUM

General Description:- **CONSTRUCTION OF LINK ROAD FROM SHAHDADPUR-LUNDO RAILWAY STATION ROAD @ MILE 3/3 TO VILLAGE GHULAM RASOOL ZARDAR I.C APPROACH TO MASJID, DISTRICT SHAHEED BENAZIRABAD.**

- | | | |
|------|---|--------------------------|
| i) | Estimated Cost | Rs. <u>40.00 Million</u> |
| ii) | Earnest Money | Rs. <u>0.80 Million</u> |
| iii) | Percentage if any to be deducted from bill @ 8% | Rs. _____ |
| iv) | Security Deposit i/c earnest money @ 10% | Rs. _____ |
| v) | Time allowed for the completion of work. | <u>06 Months</u> |

Should this tender be accepted I/We agree to a bid by and fulfill the terms and provisions of the conditions of contract annexed hereto as for as applicable and default thereof to forfeit and pay to Government the sum of money mentioned in the said conditions.

RECEIPT NO. _____ DATE _____ From _____

In respect of the sum of Rs. _____ Call Deposit No. _____ dated _____ from _____ Bank is herewith forwarded representing earnest money. The full value of which is to be absolutely forfeited to Government should I/We not deposit the full amount of security deposit as shown in the above memorandum in accordance with clause of the said conditions. Otherwise the sum of Rs. _____ shall be retained by Government on account of such security deposit as aforesaid or (B) the full value shall be retained by the Government on account of the Security specified in clause 1 (b) of the condition (Schedule-A is attached).

Contractor's
Signature

Executive Engineer
Rural Development Department
Shaheed Benazirabad

BILL OF QUANTITIES

DESCRIPTION AND RATE OF ITEMS BASED ON COMPOSITE SCHEDULE OF RATES.

ROAD PART - A

Name of Work:- CONSTRUCTION OF LINK ROAD FROM SHAHDADPUR-LUNDO RAILWAY STATION ROAD @ MILE 3/3 TO VILLAGE GHULAM RASOOL ZARDAR I.C APPROACH TO MASJID, DISTRICT SHAHEED BENAIZIRABAD.

S #	Description	Quantity	Rate	Unit	Amount
1)	Earth work for road embankment by bulldozer including plugging mixing clod breaking dressing and compacting with optimum moisture content lead up to 100ft lift up to 5ft in all type of soils except rock if earth work is done by other the departmental agency for 85 % modified A A S H O density extra two miles lead. (C.S.H.W.P.1&2 It.3, A)	1181500.0	8681.43	%o Cft	10257110.00
2)	Earth work for road embankment by bulldozer including plugging mixing clod breaking dressing and compacting with optimum moisture content lead up to 100ft lift up to 5ft in all type of soils except if earth work is done by other departmental agency for 95 -100 modified AASHO density extra two mile lead. (C.S.H.W.P.1&2 It.6(A)	209400.0	11215.37	%o Cft	2348498.00
3)	Preparing sub-base course by supplying & spreading stone metal 1-1/2"to2" gauge of approved quality from approved quarry in required thickness to proper camber and grade i/c hand packing filling voids with 10cft of screening and non plastic quarry fines of approved quality & gauge from approved source watering & compacting to achieve 98-100 % density as per modified AASHO specification rate all cost of materials T&P carriage upto 3 chains). (C.S.H.W.P.3 It.8 (A)	89700.00	8651.79	% Cft	7760656.00
4)	Laying on bricks on end edging including supply of 9" x 4 1/2" x 3" 1 st class burnt bricks excavation for laying edging with small size parallel to the road. Rate includes all cost of materials labour and carriage to the site of work.	29000.00	2750.80	% Rft	797726.00
4)	Preparing base course supplying & spreading stone metal of approved quality properly graded to maximum size of 1-1 1/2" in required thickness to proper camber & grade i/c supplying lying spreading 15cft screenings non plastic quarry fines filling depressions with stone metal after initial rolling i/c watering and compaction the same so as to achieve 100 % density as per modified AASHO specification (Rate i/c providing using templates camber plates screen from as directed) Rate all cost of material T&P carriage up to site of work. (C.S.H.W.P.No.4. It.No.10	89700.00	9671.75	% Cft	8675560.00
5)	Providing surface dressing (3 coat) on new or existing surface with (40+25+14)= 79 Lbs bitumen per Sft of 80/100 penetration from Karachi and (5.5+2.75+1.50)= 9.75 Cft crush bajri size 3/4", 1/2", 3/8", 1/8" respectively per % Sft carriage up to site of work (using crush bajri). (C.S.HWP 6 It.16, B)	179500.00	1652.68	% Sft	2966561.00
TOTAL				Rs,	32806111.00
_____ % Above / Below on the rates of CSR				Rs,	
G.TOTAL				RS,	

Rupees in Works:- _____

CONTRACTOR'S
SIGNATURE

EXECUTIVE ENGINEER
RURAL DEVELOPMENT DEPARTMENT
SHAHEED BENAIZIRABAD

BILL OF QUANTITIES

DESCRIPTION AND RATE OF ITEMS BASED ON COMPOSITE SCHEDULE OF RATES.

ROAD CULVERT PART - B

Name of Work:- CONSTRUCTION OF LINK ROAD FROM SHAHDADPUR-LUNDO RAILWAY STATION ROAD @ MILE 3/3 TO VILLAGE GHULAM RASOOL ZARDAR I.C APPROACH TO MASJID, DISTRICT SHAHEED BENAIZIRABAD.

S.#	Description	Quantity	Rate	Unit	Amount
1)	Excavation in foundation of building bridges and other structure including dug belling dressing refilling around structure with excavated earth watering ramming lead up to 5ft in ordinary soil. (C.S.P.4&5.It.18(B))	9516.96	3176.25	%o Cft	30228.00
2)	Cement concrete brick or stone ballast 1-½" to 2" gage in ratio 1:4:8 etc. (C.S.P.14.It.4(A))	2155.24	9416.28	% Cft	202943.00
3)	Pacca brick work in foundation and plinth in cement sand mortar (1:6)	3186.42	11948.36	% Cft	380725.00
4)	Erect on & removal of centering for RCC or plain C.C works of partial wood (Vertical). (C.S.P. 17. It. 19(B)).	218.34	3127.41	% Sft	6828.00
5)	Cement concrete plain including placing compacting, finishing and curing, including screening and washing of stone aggregate without shuttering. Ratio 1:2:4. (C.S.P.18.It.5(A))	564.80	14429.25	% Cft	81496.00
6)	Fabrication of mild steel reinforcement for C.C i/c cutting bending laying in position making joints and fastening i/c cost of binding wire also includes removal of rust from bars. (Use Tor Bar). (C.S.P.20.It.7(B))	37.855	4820.20	P. Cwt	182469.00
7)	R. C. C work including all labor and material except the cost of steel reinforcement its labor for bending binding which will be paid separately this rate also i/c all kinds of forms mould lifting shuttering curing rendering finishing the exposed surface i/c screening washing of shingle RCC Work in roof slab beams columns rafts lintels & other structural members laid in situ or precast laid in position complete in all respect. (C.S.P.18 19.It.6 A(i))	729.36	337.00	P Cft	245885.00
8)	Cement plaster (1:3) upto 20 ft height ½" thick	1881.00	2344.59	% Sft	44102.00
Total				Rs,	1174676.00
_____ % Above / Below on the rates of CSR				Rs,	
G.TOTAL				RS,	

Rupees in Works:- _____

CONTRACTOR'S
SIGNATURE

EXECUTIVE ENGINEER
RURAL DEVELOPMENT DEPARTMENT
SHAHEED BENAIZIRABAD

TYPICAL X-SECTION OF ROAD

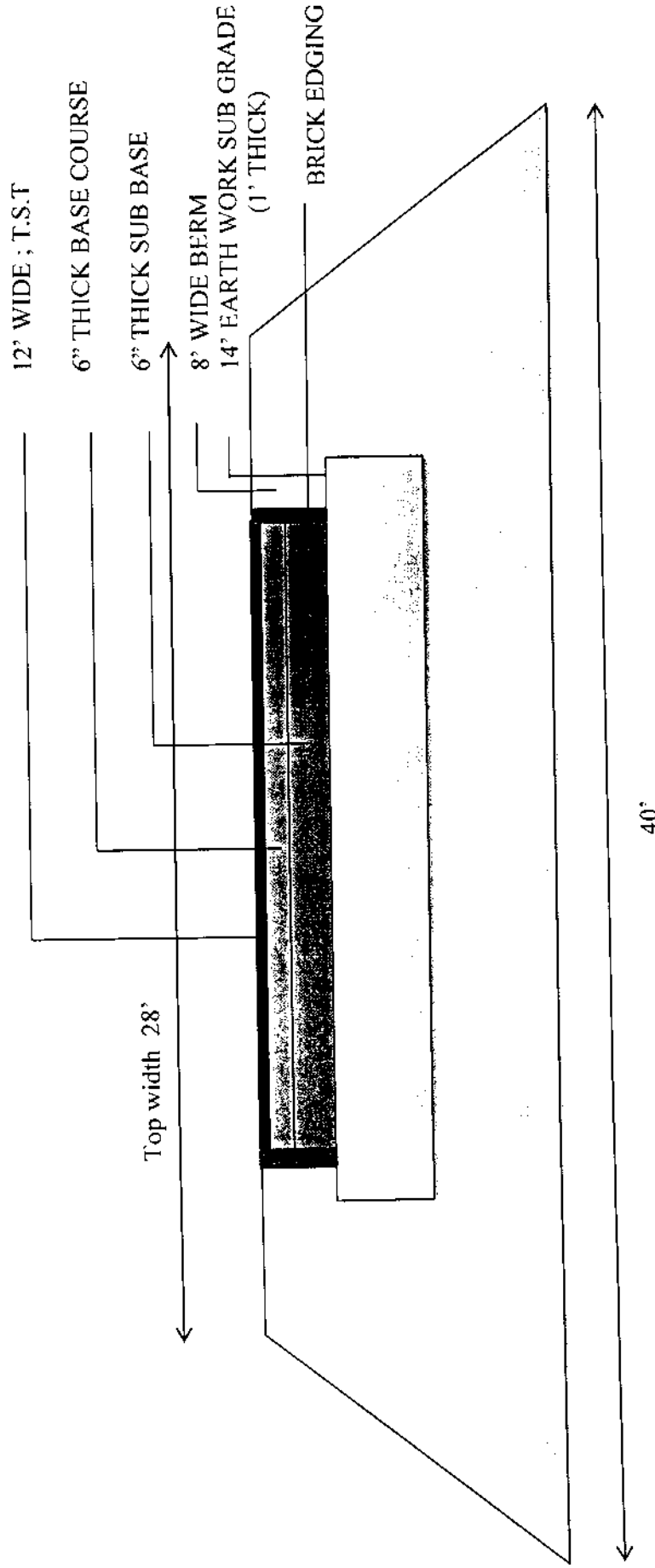

DISTRICT OFFICER (TECH)
RURAL DEVELOPMENT DEPARTMENT

